

LOCATED IN PART OF THE NW 1/4 OF THE SW 1/4 OF SECTION 31, TOWN 3 NORTH, RANGE 18 EAST  
TOWN OF SPRING PRAIRIE, WALWORTH COUNTY WI

Tax Parcel No. OA285900002

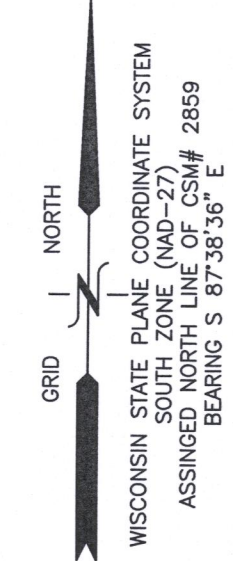

**LOT 2, CSM# 2859**  
**TITLE SURVEY**  
0902 TOWNLINE ROAD, LAKE GENEVA

— WORK ORDERED BY —  
ROSE MILLER  
623 MAIN STREET  
LAKE GENEVA WI 53147

**HARRIS, HANSEN & ASSOCIATES, INC.**  
ENGINEERING — ARCHITECTURE — SURVEYING  
7 RIDGWAY COURT P.O. BOX 437  
ELKHORN, WISCONSIN 53121  
OFFICE: (262) 723-2098 FAX: (262) 723-5886

## REVISIONS

PROJECT NO. 4632.01.22
DATE 4-20-22
SHEET NO. 1 OF 1



RECEIVED  
JUL - 7 2022  
By *SM*

NOTE: COPIES OF THIS MAP TO WHICH THE FOLLOWING CERTIFICATE WILL APPLY SHOW THE SURVEYOR'S ORIGINAL SEAL AND SIGNATURE IN RED INK. COPIES BY ANY OTHER MEANS MAY HAVE ALTERATIONS WHICH DO NOT REPRESENT THE SURVEYOR'S WORK PRODUCT.

I HEREBY CERTIFY THAT THE ABOVE DESCRIBED PROPERTY HAS BEEN SURVEYED UNDER MY DIRECTION AND THAT THE ABOVE IS A TRUE REPRESENTATION THEREOF AND SHOWS THE SIZE AND LOCATION OF THE PROPERTY, ITS EXTENT, BOUNDARIES, THE LOCATION OF ALL VISIBLE STRUCTURES, AND DIMENSIONS OF ALL PRINCIPLE BUILDINGS THEREON, BOUNDARY FENCES, APPARENT EASEMENTS, ROADWAYS, AND VISIBLE ENCROACHMENTS, IF ANY. THIS SURVEY IS MADE FOR THE USE OF THE PRESENT OWNERS OF THE PROPERTY, AND ALSO THOSE WHO PURCHASE, MORTGAGE, OR GUARANTEE THE TITLE THERETO WITHIN ONE YEAR FROM THE DATE HEREOF.

DATED: APRIL 21, 2022

CHA A.V.  
CHRISTOPHER A. HODGES P.L.S. 2760



LEGEND

● = FOUND IRON REBAR  
 ⚡ = SET IRON REBAR  
 {XXX} = RECORDED AS



X: \\Acad\_Std\\Carlson\\TITLE BLOCKS\\FHA 24x36.dwg

0A2859-2

318-1368